

# Standard Thermocouple Connector Duplex Socket



## Features

- Contacts are polarised to prevent incorrect connection
- Rugged glass filled polyester bodies, suitable for industrial applications
- Its robust design ensures long-term reliability and consistent performance, even in demanding conditions



## Specification

Sensor Type	J
Connector Size	Standard
Connector Type	Duplex Socket
Colour	Black
Max. Temperature	220°C
+Positive Contact	Fe
-Negative Contact	CuNi
Standards Met	BS EN 50212:1997; RoHS

## Drawing

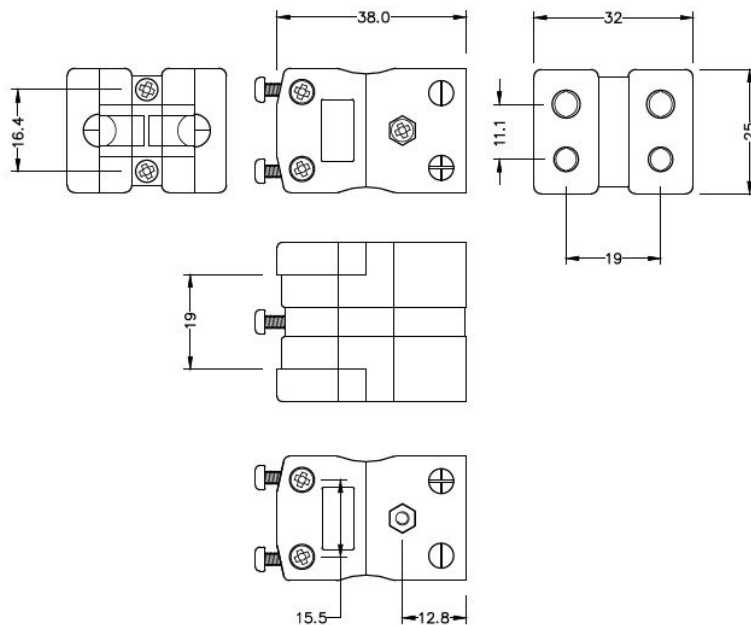

**Standard Duplex in-line Socket**  
(dimensions in mm)

Art. Nr.  
RND 410-00217